



CONSTRUCTION ALERT

- Date:** January 10, 2022
- What:** Metal Panel at The Spot (JSC) & Handrail Modifications
- When:** January 11, 2022 through January 14, 2022
- Where:** Santa Ana College, Johnson Student Center
- Work Hours:** 7:00 A.M. – 5:00 P.M.

Activities:

Beginning January 11, 2022, a metal security panel will be installed at the eastern corner of The Spot and the bottom section of the exterior handrail will be modified at the west stairway. During the construction activities, the areas highlighted in red will be closed. The northern stairwell, eastern stairwell, and building entrances will be made available. Please be careful with active construction areas delineated with caution tape.

If you have any concerns or questions, please contact Victor Muñoz at (562) 544-0051 or via e-mail at munoz_victor@rsccd.edu.

Attachment:

Johnson Student Center Site Map

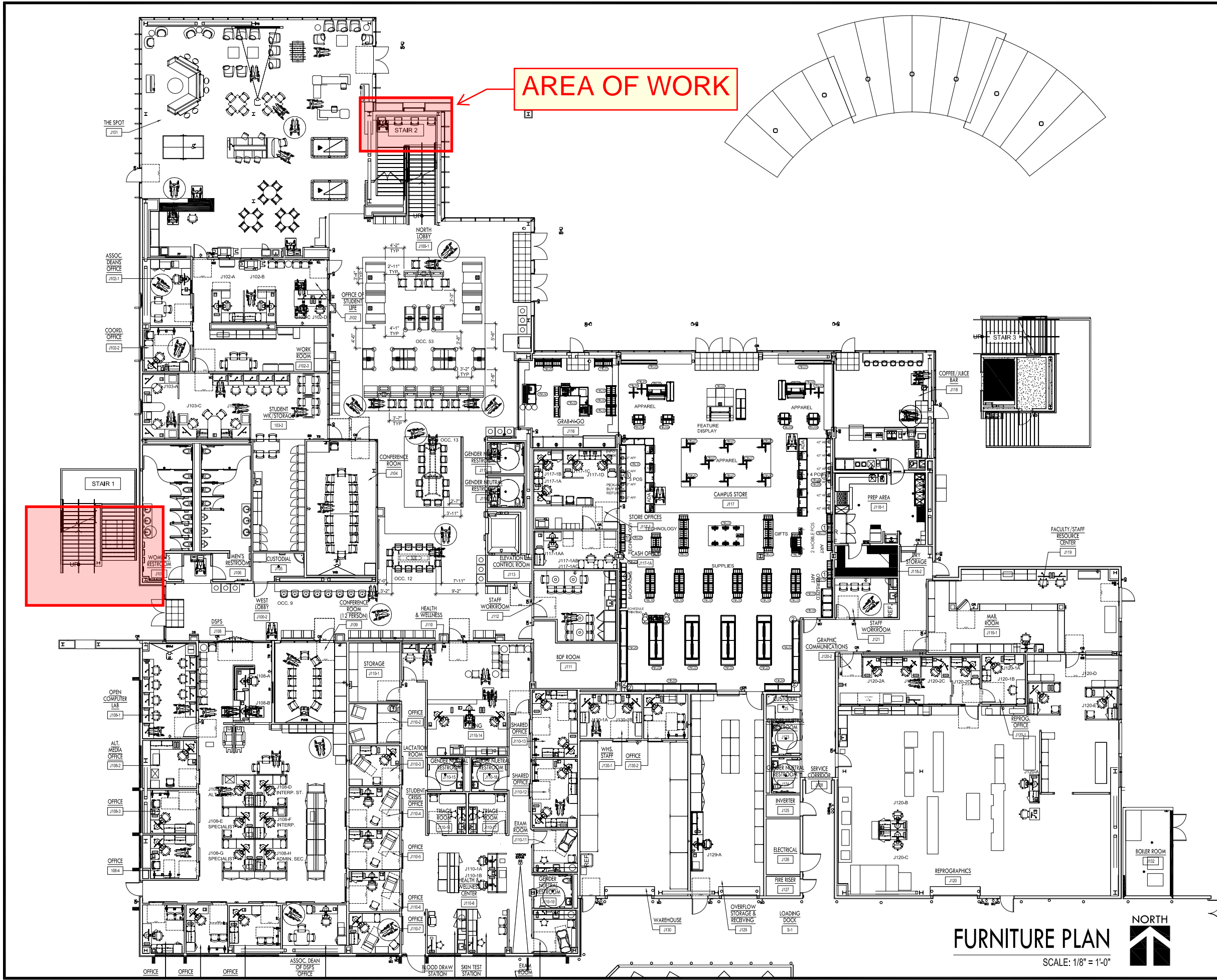

architect:

client:



approvals:

DATE:

project title:

JOHNSON CENTER FIRST FLOOR

submittals / revisions:

MARK: DATE: DESCRIPTION:

DATE: APRIL 16, 2018

PROJECT NO.: 15180.00

FILENAME: -

DRAWN BY: TP

CHECKED BY: TP

COPYRIGHT:

PAL ID

STUDIO, INC.

sheet name:

FIRST FLOOR FF&E

sheet number:

I-1.0

SHEET 1 OF 2