



CONSTRUCTION ALERT

Date: 10/26/2015

What: Construction Fencing (revised date)

When: 10/30/15 to 11/6/15

Where: Santa Ana College, Parking Lot #9

Work Hours: 7:00AM-4:00PM

Activities:

Take notice that construction fencing will be expanded in the west half portion of parking lot 9 and Contractor mobilization will take place. Office trailer drop off, install and utility hook-ups will occur and an increase in noise levels and traffic are anticipated in the surrounding area.





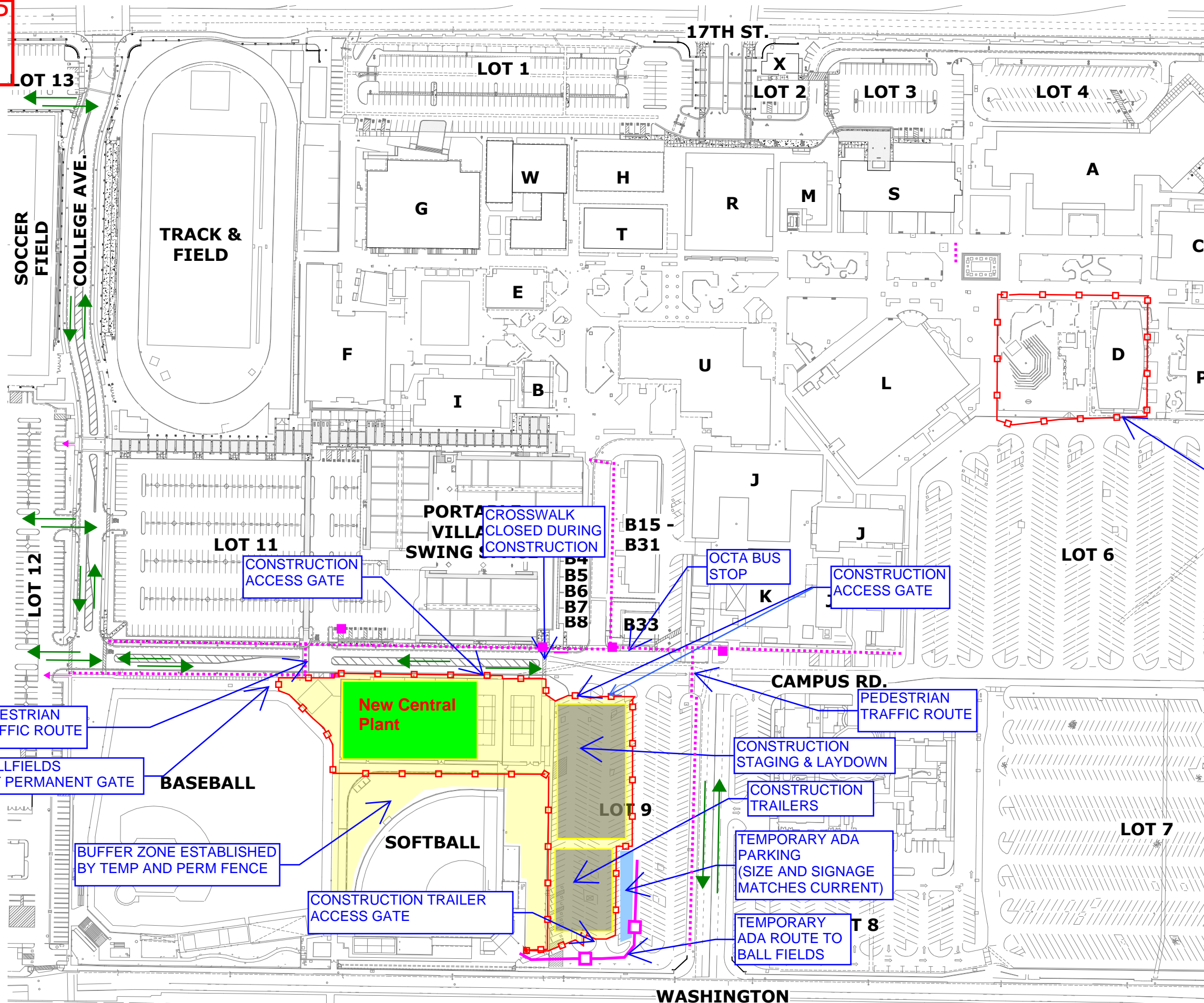

Attachment:

Partial site map of affected area

LINK CORP
10/09/2015
RECEIVED

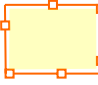

LEGEND

-  VEHICLE TRAFFIC FLOW DIRECTION
-  PEDESTRIAN TRAFFIC ROUTE
-  CONTINUED TRAFFIC ROUTE
-  CONSTRUCTION AREA & TEMPORARY FENCING
-  EXTERIOR PEDESTRIAN DIRECTIONAL SIGN
-  INTERIOR PEDESTRIAN DIRECTIONAL SIGN
-  CONSTRUCTION AREA & TEMPORARY STEEL PLATES

EXISTING DUNLOP TEMP FENCING