

**SAC Facilities Committee Meeting**  
**November 19, 2013**



**SANTA ANA**  
**COLLEGE**

# **SANTA ANA COLLEGE**

## **2014 Facilities Master Plan Update**



**SANTA ANA COLLEGE**

**HMC** Architects

# AGENDA

- Facilities Master Plan Update
- Phasing
- Next Steps



# FACILITIES PLANNING PRINCIPLES

- Maximize functional space
  - Renovate facilities to support program needs
- Eliminate non-functional space
  - Remove temporary buildings
  - Replace aging facilities
- Improve efficiency / utilization of facilities
  - Consolidate related programs
  - Create flexible, interdisciplinary spaces
  - Maximize utilization of facilities / explore scheduling options
  - Incorporate sustainable features to improve efficiency and reduce operating costs
- Right- size the campus to address program needs
  - Align the space inventory with state guidelines
  - Position the College to maximize funding (state and local)
- Develop the campus environment
  - Define clear, inviting campus entry points
  - Develop clear pedestrian connections
  - Create gathering spaces to support collaboration







W 17TH STREET



15TH STREET

MARTHA LANE

N BRISTOL STREET

W WASHINGTON AVENUE



# BUILDING PLANNING

- STEM Building
- Fine + Performing Arts Complex



# SCIENCE, TECHNOLOGY, ENGINEERING + MATH BUILDING

- Building Planning

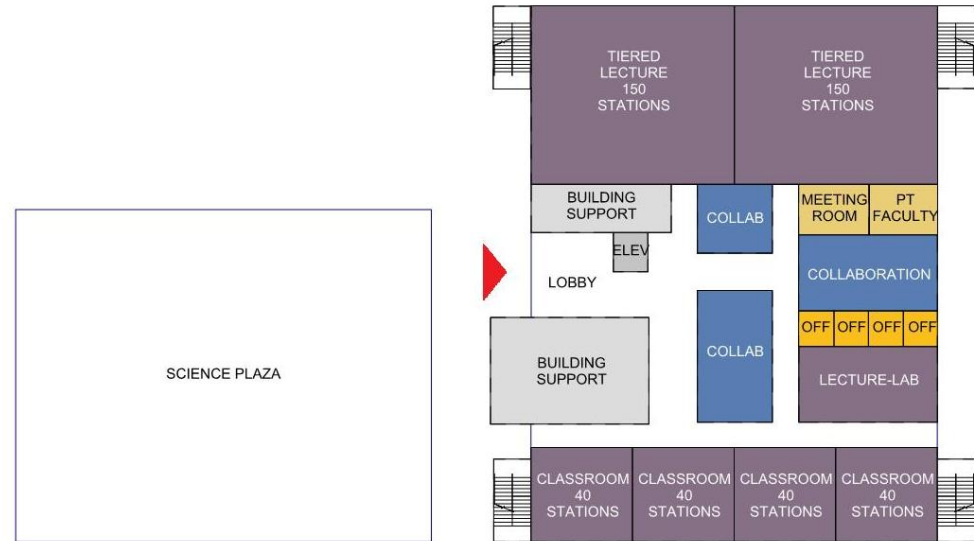

HEALTH SCIENCE BUILDING- LEVEL ONE

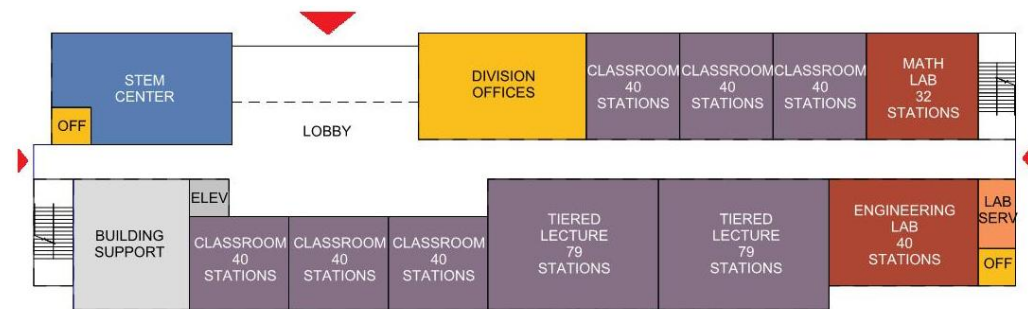

STEM BUILDING - LEVEL ONE  
SCALE: 1/32" = 1'-0"



# SCIENCE, TECHNOLOGY, ENGINEERING + MATH BUILDING

- Building Planning

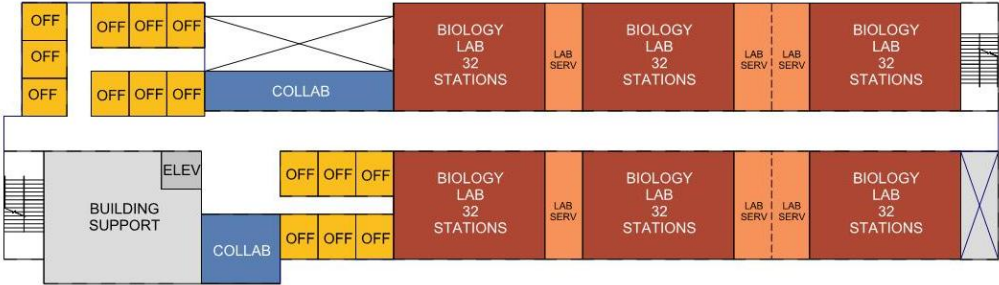

LEVEL TWO

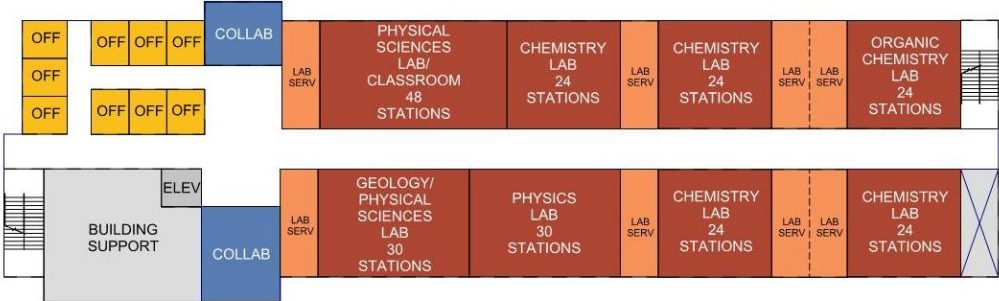

LEVEL THREE

Scale: 1/32" = 1'-0"





# FINE + PERFORMING ARTS COMPLEX

- Final Project Proposal

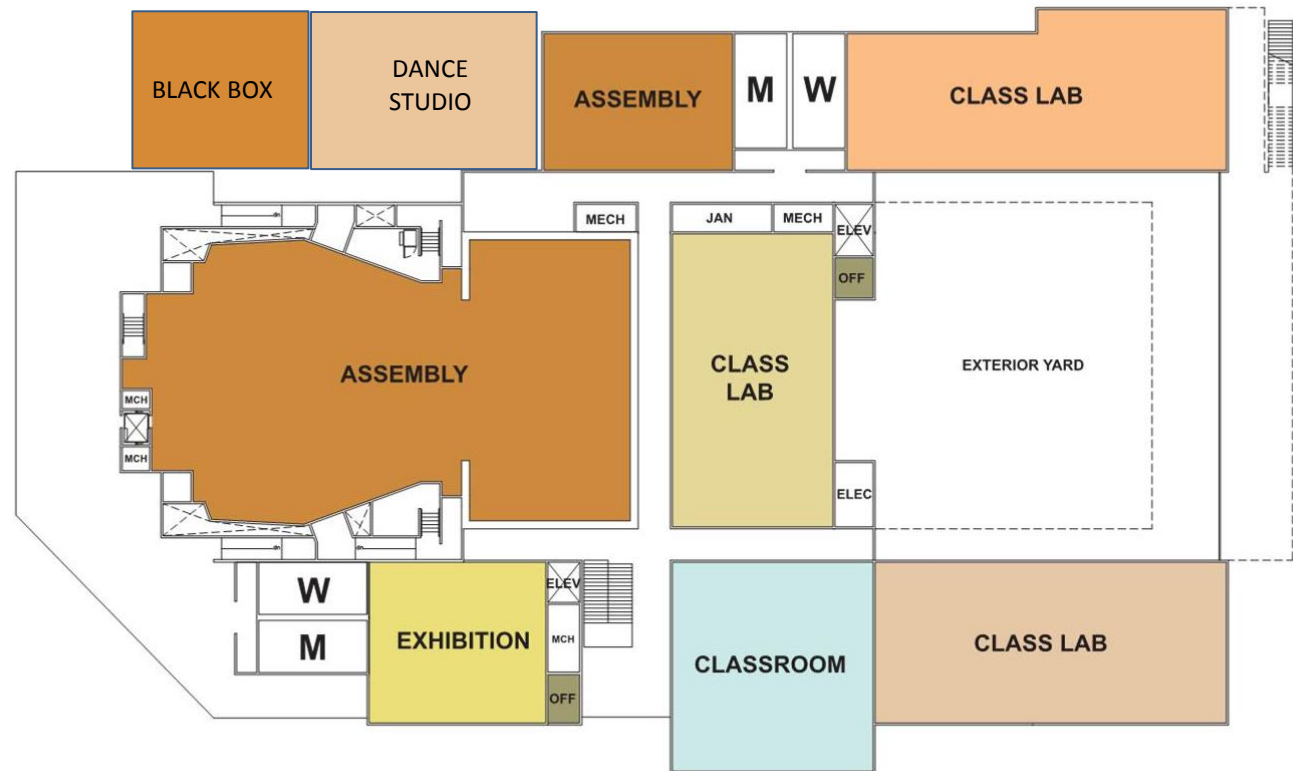

# FINE + PERFORMING ARTS COMPLEX

- Final Project Proposal

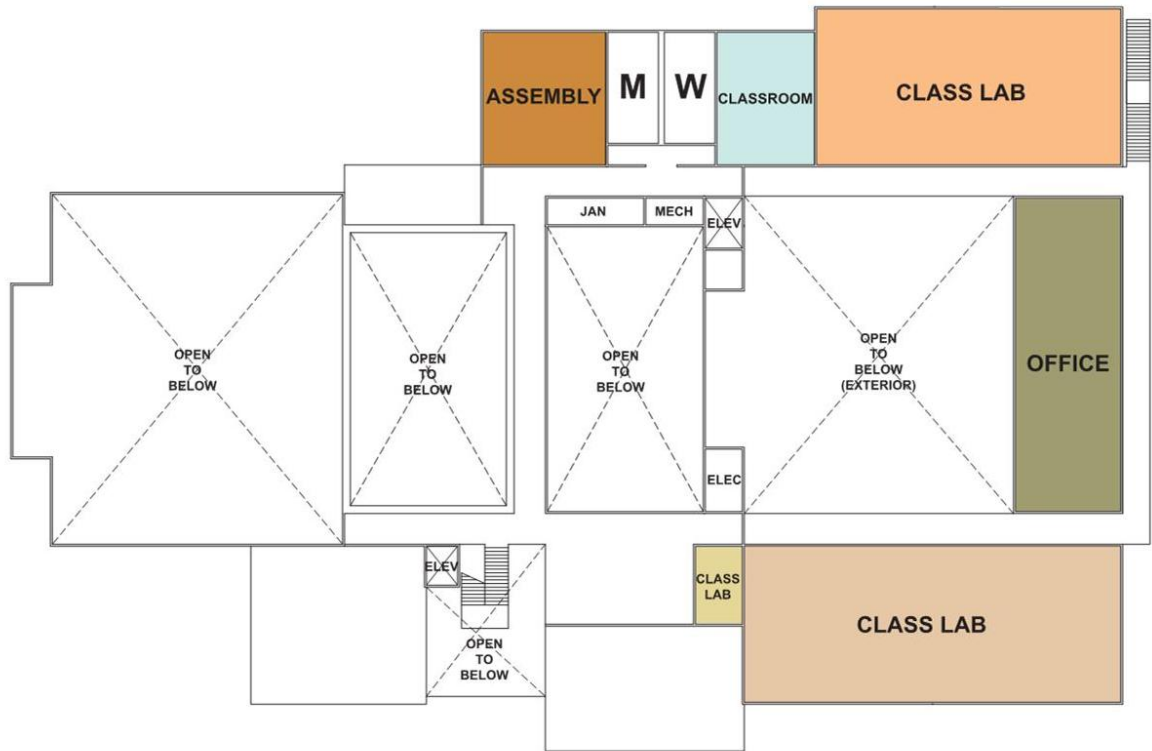

# PRELIMINARY PHASING AND IMPLEMENTATION

## CRITERIA

- Limit disruption to campus and programs
- Follow the logical sequence of moves
- Maximize local and state funding of projects
- Expedite projects that allow others to follow
- Limit the number of temporary moves required
- Limit the need for swing space



**SOCCER FIELD**

**STADIUM IMPROVEMENTS**

**GYM RENOVATION**

**CAMPUS ENTRIES +  
EDGE IMPROVEMENTS**

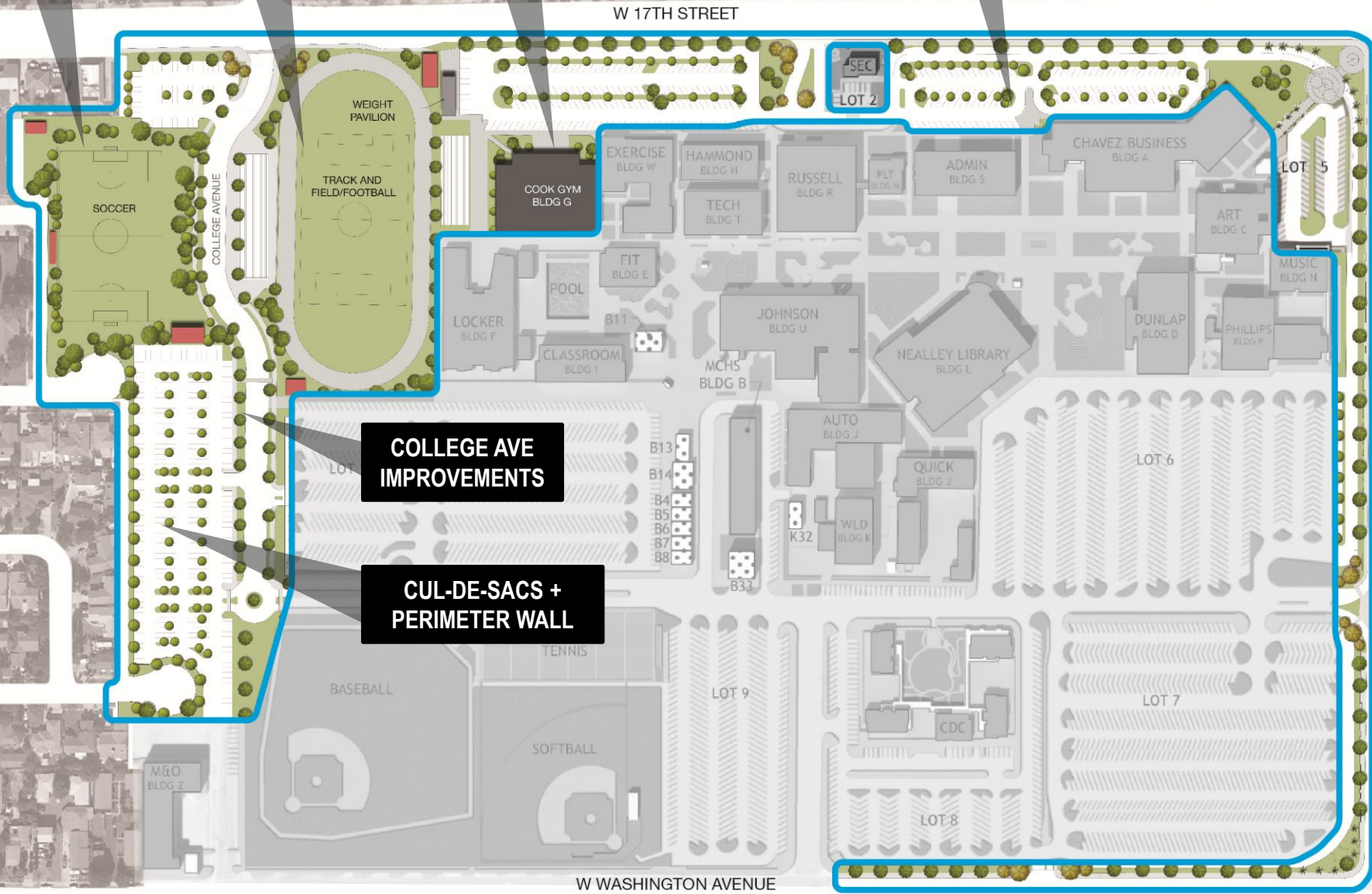

**COLLEGE AVE IMPROVEMENTS**

**CUL-DE-SACS +  
PERIMETER WALL**

W 17TH STREET

W WASHINGTON AVENUE

N BRISTOL STREET



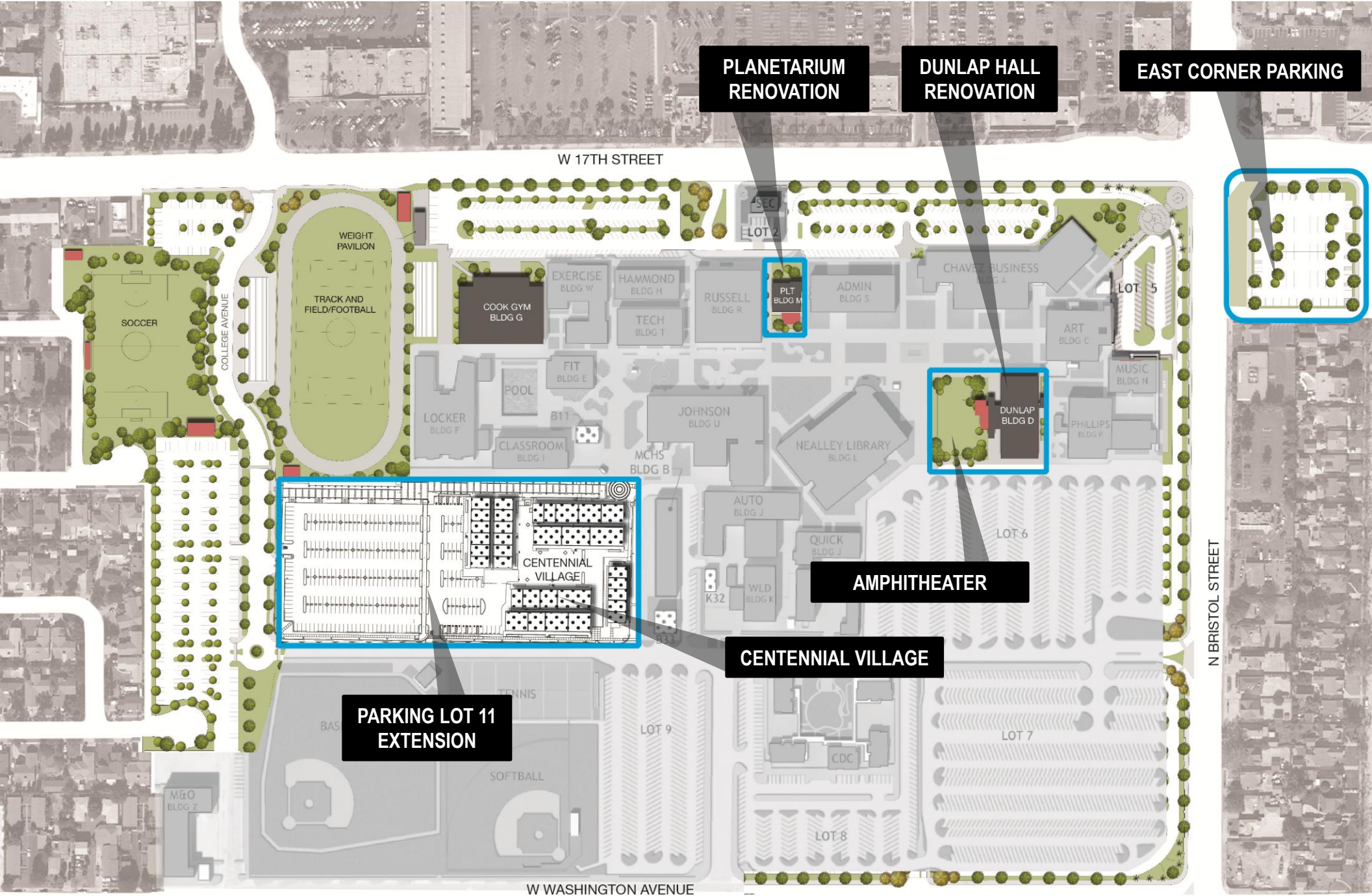

**JOHNSON CENTER  
RENOVATION**

**CHAVEZ HALL  
RENOVATION**

W 17TH STREET

SEC  
LOT 2

CHAVEZ BUSINESS  
BLDG A

LOT 5

SOCCER

WEIGHT  
PAVILION  
TRACK AND  
FIELD/FOOTBALL

COOK GYM  
BLDG G

EXERCISE  
BLDG W

HAMMOND  
BLDG V

RUSSELL  
BLDG R

PLT  
BLDG M

ADMIN  
BLDG S

ART  
BLDG C

COLLEGE AVENUE

LOCKER  
BLDG F

POOL

FTI  
BLDG E

B11

JOHNSON  
BLDG U

NEALLEY LIBRARY  
BLDG L

DUNLAP  
BLDG D

MUSIC  
BLDG N

PHILLIPS  
BLDG P

CLASSROOM  
BLDG I

**CAMPUS MALL IMPROVEMENTS +  
INFRASTRUCTURE REPLACEMENT**

CENTENNIAL  
VILLAGE

K32

WLD  
BLDG K

STEM &  
LECTURE

CAMPUS ROAD

N BRISTOL STREET

BASEBALL

CENTRAL  
PLANT

TENNIS

**STEM BUILDING**

SOFTBALL

**CENTRAL PLANT**

M&O  
BLDG Z

W WASHINGTON AVENUE

**SOUTH CAMPUS CIRCULATION  
IMPROVEMENTS**

**PARKING LOTS 6 + 7  
IMPROVEMENTS**



**SANTA ANA COLLEGE**

**PHASE 3**

HMC Architects



**LIBRARY**

W 17TH STREET

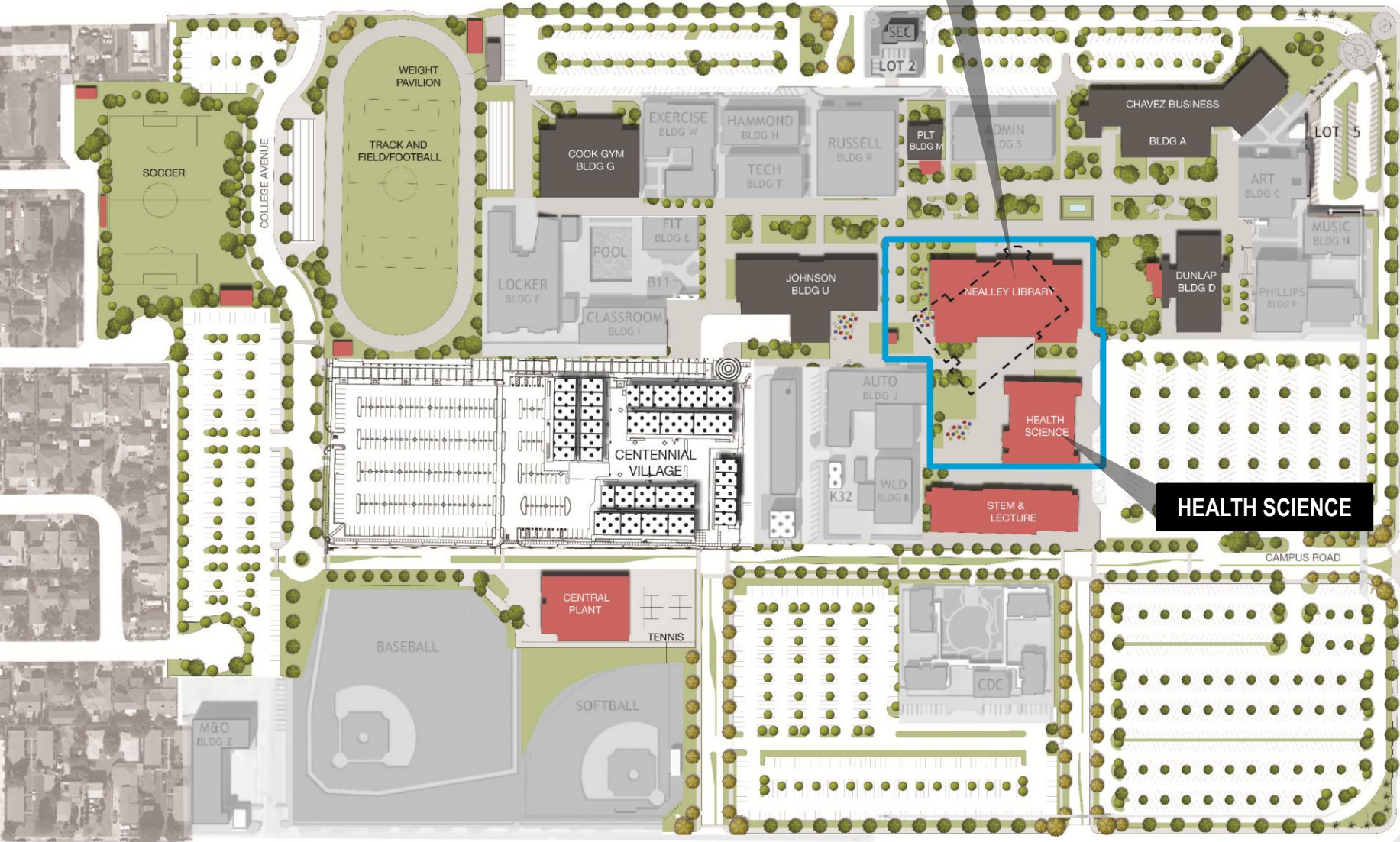

**HEALTH SCIENCE**

N BRISTOL STREET

W WASHINGTON AVENUE



**STUDENT SERVICES +  
INSTRUCTIONAL BUILDING**

**ENTRY COURT**

**ADMIN BUILDING  
RENOVATION**

**FINE + PERFORMING  
ARTS COMPLEX**

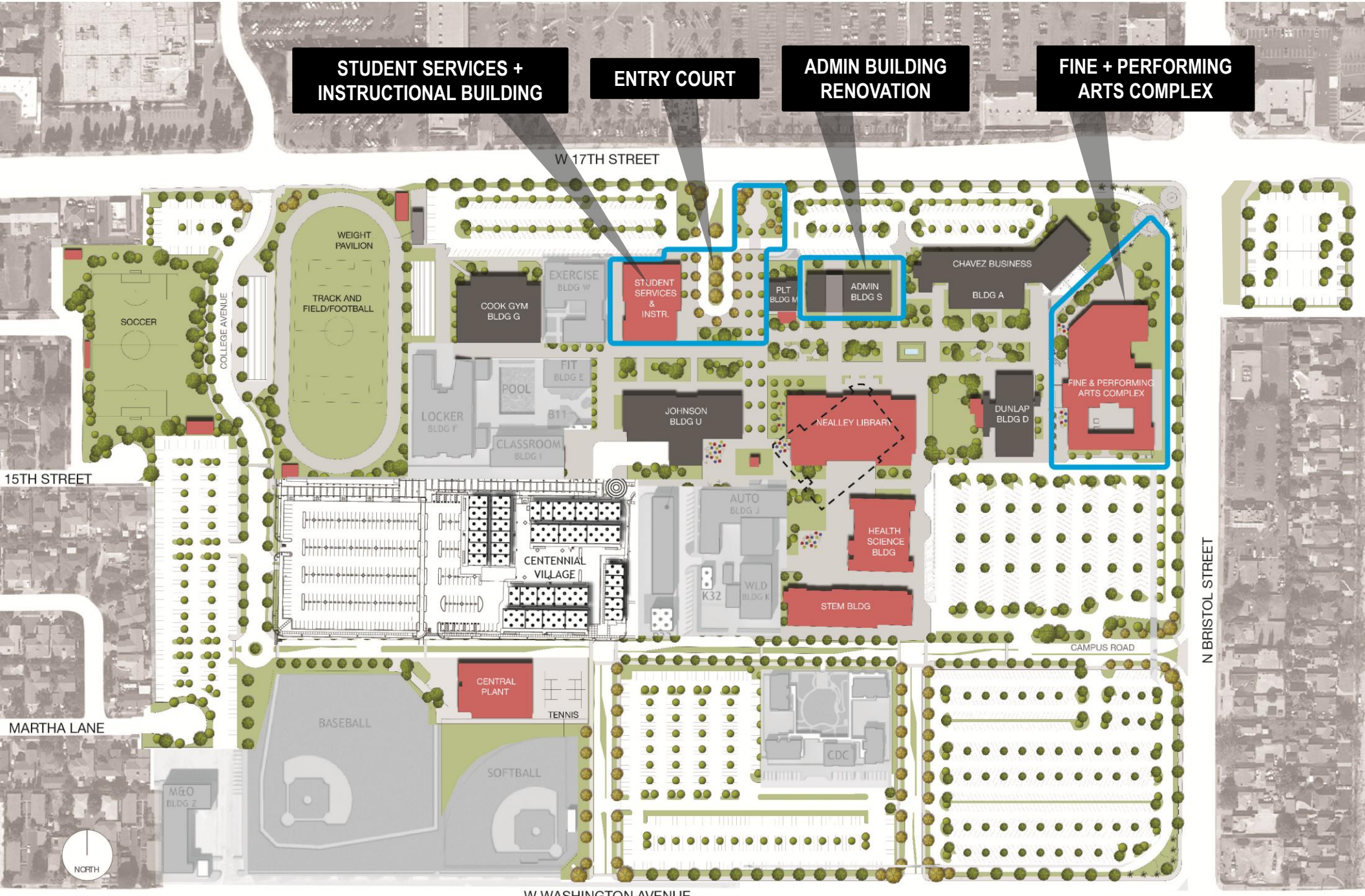





W 17TH STREET

15TH STREET

MARTHA LANE

W WASHINGTON AVENUE

N BRISTOL STREET





W 17TH STREET

15TH STREET

MARTHA LANE

NORTH

W WASHINGTON AVENUE

N BRISTOL STREET

CAMPUS ROAD



# AGENDA

- Facilities Master Plan Update
- Phasing
- Next Steps

